

# Sanitary, Low-Flow Cleaning

## Toftejorg SaniMidget Rotary Spray Head

### Application

The Toftejorg SaniMidget is an efficient replacement for traditional static spray balls as it uses low volumes of liquid at low pressure. The device, particularly well-suited to sanitary applications, can be used in tanks ranging from 0.1 to 10 m<sup>3</sup> (27 to 2,700 US gallons). Application and optimal positioning assistance is available in CAD format. In addition, the Toftejorg SaniMidget meets the requirements of the ATEX directive 94/9/EF, EEX group II, category 1 GD, zone 0, C T140° C.

### Working principle

The flow of the cleaning media causes the head of the Toftejorg SaniMidget to rotate, with fan jets laying out a swirling pattern throughout the vessel. This generates a vibrating impact and cascading flow that covers all internal surfaces of the tank or reactor. The device's self-cleaning feature is achieved by directing the cleaning media through the rotating bearing track and onto the neck of the elongated head.

### Spray Pattern

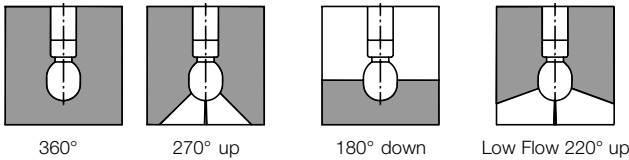

### Standard Design

As standard documentation, the Toftejorg SaniMidget can be supplied with a "Declaration of Conformity" for material specifications or 3.1.B certification for metallic parts. The device is available in an electro-polished version as well as in hastelloy C22 (balls in hastelloy C276/PFTE) with 3.1.B certification for metallic parts.

### Materials

Inlet connections: . . . . . 1.4404 (316L)  
 Bearing race parts: . . . . . SAF 2205 (UNS31803)  
 Balls: . . . . . 1.4404 (316L)/PTFE\*  
 Head: . . . . . 1.4404 (316L)

(\*FDA approved 21 CFR § 177.1550)

### Technical Data

Weight: . . . . . Thread and clip-on: 0.30 kg  
 (0.66 lbs)  
 On pipe: 0.55/0.90 kg  
 (1.21/1.98 lbs)  
 Lubricant: . . . . . Self-lubricating with the  
 cleaning fluid  
 Working pressure: . . . . . 1 - 3 bar (14.5 - 44 psi)  
 Recommended pressure: . . . . . 2 bar (29 psi)  
 Max. working temperature: . . . . . 95 °C (203 °F)  
 Max. ambient temperature: . . . . . 140 °C (284 °F)  
 Wetting radius: . . . . . Max. 3 m (10 ft)  
 Impact cleaning radius: . . . . . Max. effective 1.4 m (4 ft)



Connections: . . . . . 1/2" or 3/4" BSP or NPT  
 thread  
 Clip-on or weld-on for pipe:  
 ISO2037, ASTM A270,  
 BS4825 part 1 or DIN  
 11.850

### Ordering

Please specify desired spray pattern, required connections, material selection and type of certification required. Please also confirm the application suitability.

### Options

A. Downpipes with Tri-Clamp and flange connections

**Flow Rate**

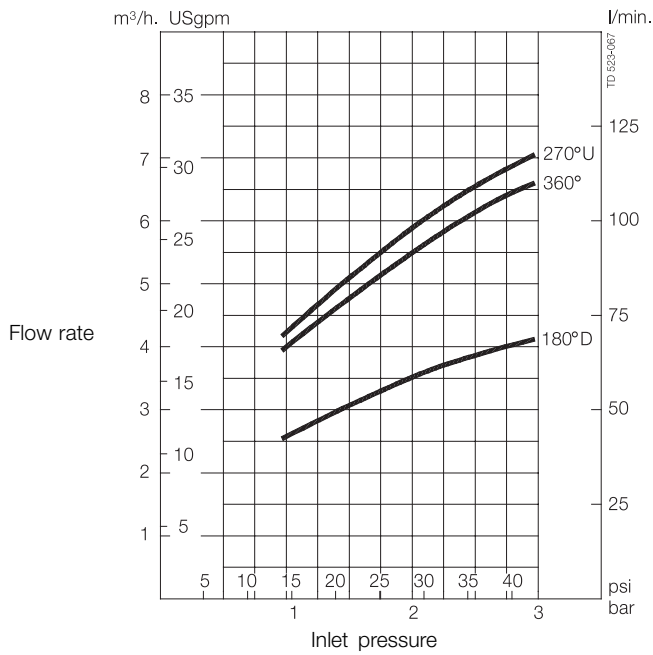

**Cleaning Radius**

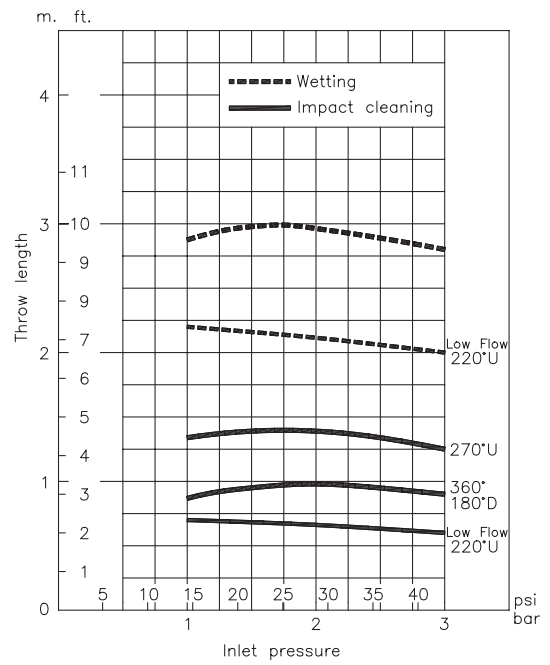

For clip-on models, the flow rate is increased by approx 0.5 m<sup>3</sup>/h.

**Dimensions (mm)**

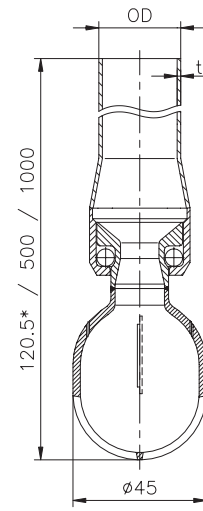
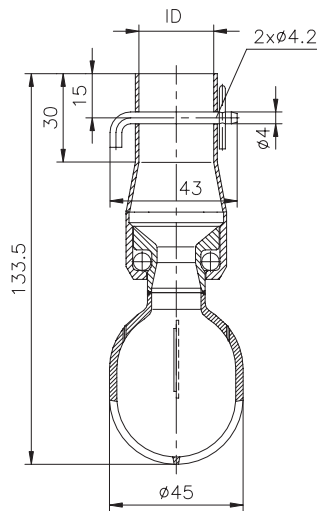
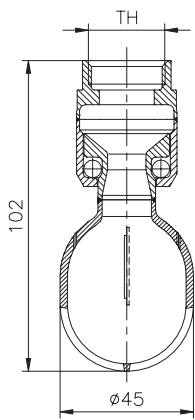

- TH**  
 1/2" BSP  
 3/4" BSP  
 1/2" NPT  
 3/4" NPT

- ID**  
 ISO: ø25.3  
 US: ø25.7  
 DIN Reihe 1: ø28.3  
 DIN Reihe 2: ø29.3

- OD x t**  
**Welded on pipe**  
 1" ISO: ø25 x 1.2  
**Weld end\***  
 1" ISO: ø25 x 1.2  
 NW25DIN: ø29 x 1.5