



FLOW
LEVEL
PRESSURE
ANALYTICAL
TEMPERATURE
INSTRUMENTATION
PASTEURIZATION CONTROLS

Sanitary Differential Level Transmitter (TDL)

Electronic sensors eliminate hard-to-install capillaries and solves temperature and position compensation issues

Dual transmitter output eliminates one transmitter and its associated process penetration

Smaller diaphragm size simplifies spud and sensor installation

Meets intrinsic safety requirements, HART protocol optional

Operates on 24 Vdc power

Multifunction integral LCD display is standard

Quick Disconnect Receptacles with optional Field Wireable Connectors

The Anderson TDL transmitter combines all the benefits of a completely electronic DP level transmitter with features that improve performance and application breadth. By incorporating our proven SL Driftless Level transmitters as primary inputs, installation, calibration, and long-term stability are all greatly enhanced versus competitive solutions. Furthermore, we designed the new transmitter to operate on 24 Volt DC power, meet intrinsic safety requirements for hazardous locations, and provided a HART protocol option.

With its NEMA 4X Stainless Steel enclosure and integral LCD Display, the transmitter can be mounted anywhere it's most convenient using standard electronic cabling for sensor and output wiring. Dual outputs are standard, with DP (level) as the primary output, with the secondary selectable for "top" (pressure and/or vacuum) or bottom (total tank pressure). In most applications this can save up to \$1800 by eliminating a secondary transmitter and process connection.

Finally, we've added additional sensor fittings for simple

retrofitting to sanitary tank spuds and ANSI flanges. The new TDL is now ready for virtually any level application where pressure and/or vacuum conditions exist.

Complete specifications and ordering information are available on the reverse. For more information please visit our Web Site at www.andinst.com, or contact your local Authorized Anderson Distributor.



Sanitary Differential Level Transmitter Specifications

DIFFERENTIAL (LEVEL) OUTPUT

Low Range: 0-50" w.c. min span
0-415" w.c. max span
Medium Range: 0-100" w.c. min span
0-830" w.c. max span
High Range: 0-170" w.c. min span
0-1385" w.c. max span

SECONDARY OUTPUT (PRESSURE AND/OR VACUUM)

Low Range (HD1):

Min Span: 50" w.c.
Max Span: 775" w.c.
Min Low End: -360" w.c. (=26.48" Hg)
Max Low End: 0" (zero-inches) w.c.

Medium Range (HD2):

Min Span: 100" w.c.
Max Span: 1,190" w.c.
Min Low End: -360" w.c. (=26.48" Hg)
Max Low End: 0" w.c.

High Range (HD3):

Min Span: 170" w.c.
Max Span: 1,745" w.c.
Min Low End: -360" w.c. (=26.48" Hg)
Max Low End: 0" w.c.

PERFORMANCE SPECIFICATIONS

Calibrated Accuracy: $\pm 0.25\%$ of URL
(1" w.c. for low range,
2" w.c. for medium range;
3.5" for high range)
Repeatability: $\pm 0.08\%$ of URL
Stability: $\pm 0.2\%$ of URL per 10°F (-12°C)
Resolution: Less than 0.1% of URL
Hysteresis: $\pm 0.07\%$ of URL
Linearity: $\pm 0.1\%$ of URL
(Best Fit Straight Line)
Over-Range Capacity: 60 psig - low/med range
100 - psig high range

TEMPERATURE SPECIFICATIONS

Process Temp. Limits: 0°- 300°F (-18°-149°C)
Ambient Temp. Limits (sensor only): 15°- 150°F
(-9°C-65°C)
Compensated Temp. Range (sensor only):
(Process) 0°- 270°F
(-18°C-132°C)
(Ambient) 15°- 150°F
(-9°C-65°C)
Ambient Temp. Limits (trans. enclosure):
15° to 120°F (-9°C-48°C)
Temperature Shock (system): -1" to +4" w.c.
per 100°F (38°C)
instantaneous change.
Within spec in five min.

ELECTRICAL

Signal Output: 4-20 mA DC for level output;
4-20 mA DC for pressure/
vacuum/total output
Transmitter Enclosure Power: External Source,
18-30 VDC, 92mA
(spec where power
supply utilized for
Transmitter only)
Loop Power: External Source, 12-30 VDC,
25mA (req'd for each loop)
(spec where power supply utilized
for Output Loops only)
Common Power Supply: 18-30 VDC, 150mA (spec
where power supply utilized for
both Loops and Transmitter)
Cable Recommended: 2 conductor, stranded, 18-24
AWG, shielded with ground.
0.17 - 0.26" Cable Sheath OD
for use with field wiring
connector.
Receptacle: Turck minifast (R) 3-pin,
NEMA 4x/IP65 connected or
disconnected.

MATERIAL AND CONSTRUCTION

Ratings: NEMA 4X, IP65
Transmitter Housing: 304 Stainless Steel
Dimensions: 7.87" W x 9.84" H x 5.91" D
Integral LCD: Liquid Crystal, 0.625" high digit
Window Material: Polycarbonate
Sensor Material: 304 and 316 SS finished to
maximum $R_a = 32$ microinches
Wetted Parts: 316L SS, electropolished to
maximum $R_a = 15$ microinches
Wetted Parts-Special: Hastelloy "C" diaphragm
optional

AGENCY APPROVALS

Hazardous Locations: Intrinsically safe for use in
Class 1, Div. 1, Groups A-D
(UL Listed)
Electromagnetic
Compatibility: CE Compliant (accuracy degrades
up to 1.1% due to line conducted
disturbance by RF Field in frequency
range 0.8 to 1.8 MHz).
Standards: 3-A compliant; Third party verified in
accordance with standard 74-00
Designed and manufactured to sound
engineering practices in accordance
with Article 3.3 of the PED 97/23/EC

HOW TO ORDER

TRANSMITTER

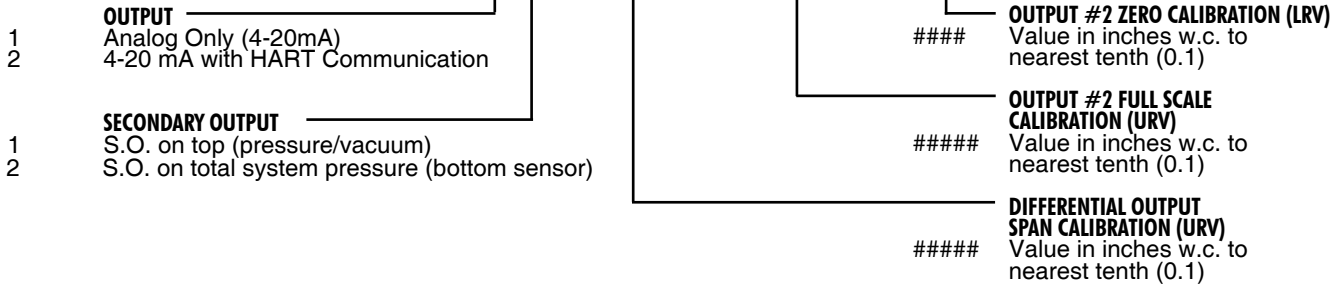

SENSOR

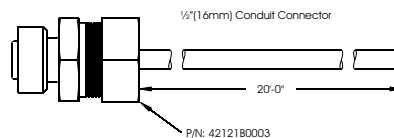
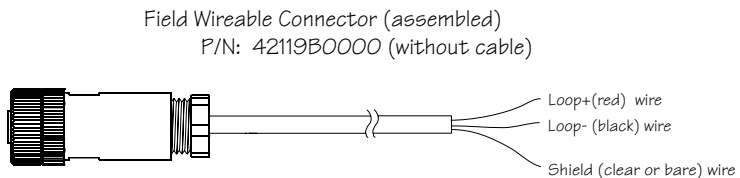
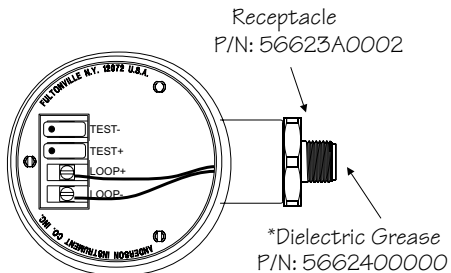
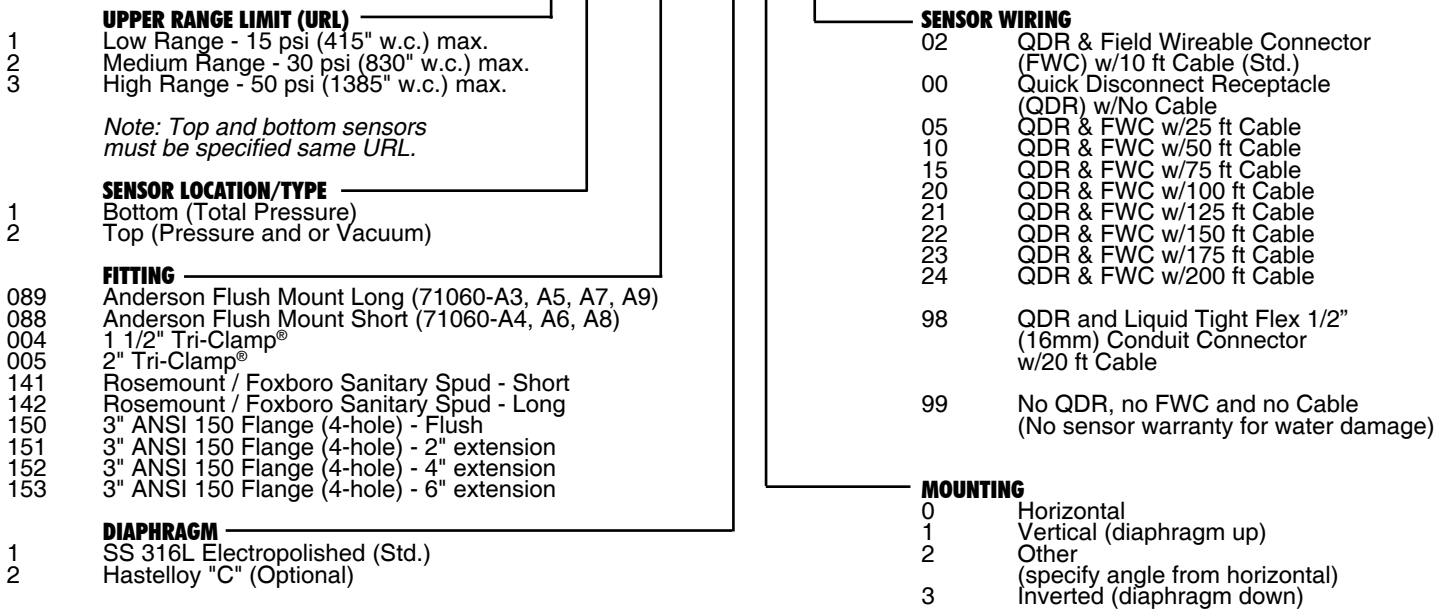

Sensor Fittings and Dimensions

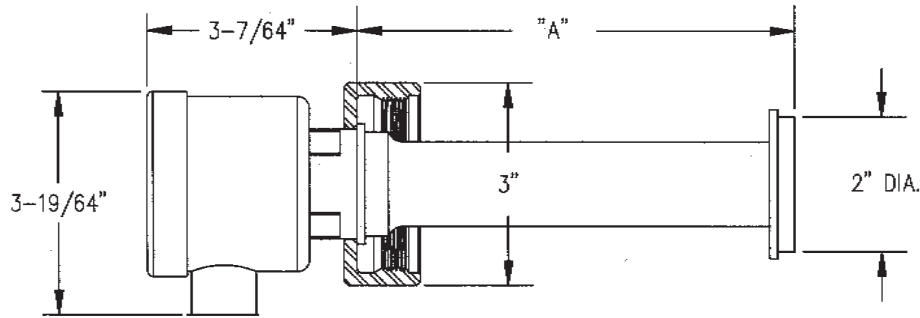

ANDERSON SHELL TYPE	"A"
NON INSULATED	2-3/16
INSULATED	6-1/2

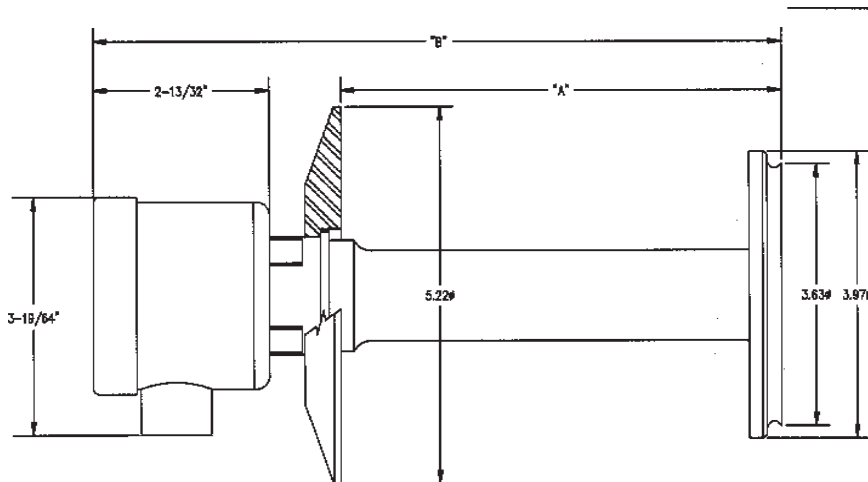
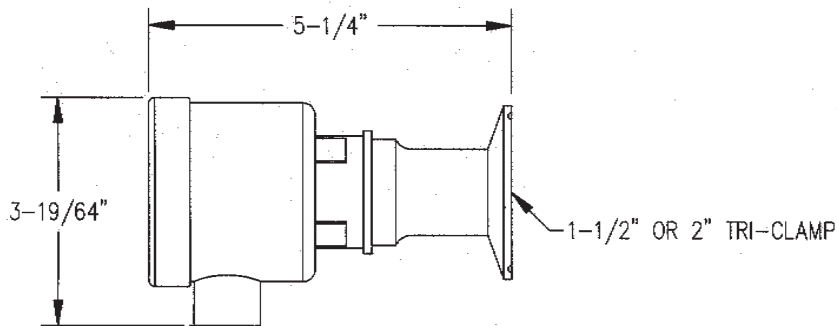

FITTING	"A" DIM.	"B" DIM.
ROSEMOUNT SHORT	2.11"	5-1/2"
ROSEMOUNT LONG	6.11"	9-1/2"